

© The copyright of the drawings and designs contained therein remains vested in the PRC Group

[illegible]

UNIT 5	
GIA Ground (ft ²)	11,957
GIA First (ft ²)	1,451
GIA Total (ft ²)	13,408
Min GEA to be achieved (m ²)	1,297

UNIT 6	
GIA Ground (ft ²)	9,597
GIA First (ft ²)	1,390
GIA Total (ft ²)	10,987
Min GEA to be achieved (m ²)	1,058

UNIT 7	
GIA Ground (ft ²)	9,135
GIA First (ft ²)	1,260
GIA Total (ft ²)	10,395
Min GEA to be achieved (m ²)	1,013

For landscape refer to Landscape Architects' design



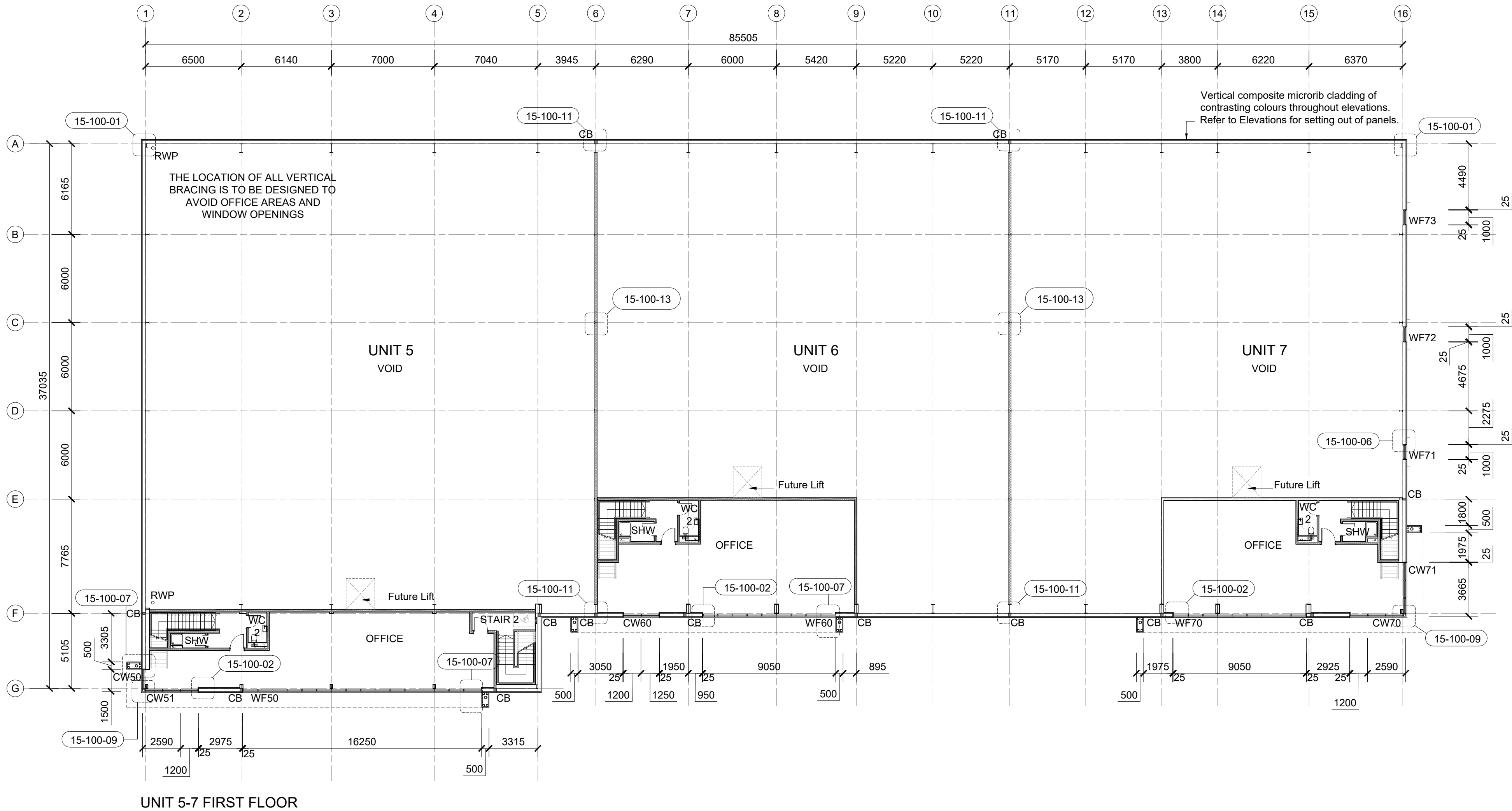

UNIT 5	
GIA Ground (ft ²)	11,957
GIA First (ft ²)	1,451
GIA Total (ft ²)	13,408
Min GEA to be achieved (m ²)	1,297

UNIT 6	
GIA Ground (ft ²)	9,597
GIA First (ft ²)	1,390
GIA Total (ft ²)	10,987
Min GEA to be achieved (m ²)	1,058

UNIT 7	
GIA Ground (ft ²)	9,135
GIA First (ft ²)	1,260
GIA Total (ft ²)	10,395
Min GEA to be achieved (m ²)	1,013

Drawing to be read in conjunction with:

- NBS Specification
- 10 Series - Site information
- 13 Series - Floor plans & elevations
- 15 Series - General arrangement sections
 - Section details
 - Plan details
- 17 Series - Stairs
- 18 Series - Core layouts
 - WC layouts
- 19 Series - Roof plans
- 20 Series - Reflective ceiling plans
- 22 Series - Doors
- 24 Series - Windows
- 30 Series - Fire Strategy
- 31 Series - Finishes Schedule

Refer to M & E Engineer's specification for all engineering services

For steelwork refer to Structural Engineer's design

For landscape refer to Landscape Architects' design



Client:
READIE CONSTRUCTION
MARSHGATE GROUP

Project:
HORIZON 120 - EOS

Drawing Title:
UNIT 5-7
FIRST FLOOR PLAN

Scale @ A1: 1:200
Checked by: JR
Date: JUN 22

Job No: 11439
Stage: WD
Drawing No: 13-103
Rev:

Issue Status:
Construction ☒ Preliminary ☐
Information ☐ Approval ☐
Tender ☐

PRC Architecture & Planning



12 Warren Yard,
Warren Park,
Milton Keynes,
MK12 5HW
01908 305 246

info@prc-group.com
www.prc-group.com

Architecture
Planning
Master Planning
Urban Design
Interiors
Landscape

Offices
Woking
London
Milton Keynes
Warsaw